

Members of Council

RICHARD NUCCI
President

PETER FISET
Vice President

JERRY ELLIS
DENISE EMBREY
JIM MARSILIO
SUE RADZANOWSKI
SAMANTHA WILFERT



MAYOR,
SHARON STETZ
(412) 921-3625
SECRETARY
CONNIE KLAUCK
(412) 921-3625
CHIEF OF POLICE
JACK DOHERTY
(412) 921-6969
TAX COLLECTOR
JORDAN TAX
(412) 835-5243

40 WEST PROSPECT AVENUE ♦ PITTSBURGH, PA 15205-2241 ♦ FAX (412) 921-5088

NOTICE: Upcoming Road Closure and Detour Information

Dear Residents,

Please be advised that starting on **April 27, 2026**, Ingram Avenue will be closed to all through traffic between **Foster Avenue** and **Vancouver Avenue**. This closure is necessary to safely complete the Ingram Avenue Improvements Project.

The work is expected to last approximately 8 weeks, weather permitting.

Detour Information:

To minimize disruption, the following detour routes have been established and will be marked with Detour arrows.

1. COMING FROM WEST PROSPECT AVENUE TURN ONTO BERRY STREET, RIGHT ON CENTER STREET, RIGHT ON CROSS STREET, LEFT ON NOBLE AVENUE, RIGHT ON STEUBEN STREET, RIGHT ON FOSTER AVENUE.

ACCESS TO 7-11 WILL REMAIN OPEN FROM WEST PROSPECT AVENUE ONLY.

2. COMING FROM INGRAM AVENUE TURN ON FOSTER AVENUE, LEFT ON STEUBEN STREET, LEFT ON UNION AVENUE, LEFT ON CENTER STREET, LEFT ON BERRY STREET.

ACCESS TO *CHERYL'S DAYCARE* WILL REMAIN OPEN FROM INGRAM AVENUE ONLY.

3. FOR RESIDENTS LIVING ON VANCOUVER AVENUE, MARCROSS AVENUE, AND MABERLY STREET: THE ACCESS TO YOUR HOMES WILL BE FROM WEST PROSPECT AVENUE AT VANCOUVER AVENUE ONLY.

*****VANCOUVER AVENUE AND MARCROSS AVENUE WILL BE CHANGED TO TWO-WAY TRAFFIC DURING THE ENTIRE PROJECT. THERE WILL BE NO ACCESS FROM MACROSS AVENUE TO INGRAM AVENUE DURING THIS TIME.**

ACCESS TO REGE'S BARBER SHOP AND KRUPP WHITNEY PLUMBING PARKING LOTS WILL BE AVAILABLE VIA CRAIG WAY. THERE WILL BE NO ACCESS FROM CRAIG WAY TO INGRAM AVENUE DURING THIS TIME.

- 4. EAST PROSPECT AVENUE BRIDGE WILL REMAIN CLOSED DURING THE ENTIRE PROJECT.**
- 5. KRESTON STREET WILL BE CHANGED TO TWO-WAY TRAFFIC DURING THE PROJECT.**

Phase 2 Construction Information:

The mill and overlay of Ingram Avenue from Foster Avenue to Borough line. Along with sewer work and ADA ramps.

This section of Ingram Avenue will not be closed during this time. There will be lane closures and flaggers controlling the flow of traffic. Expect and prepare for delays.

Driveways will have limited access during this short phase of the project.

Important Resident Notes:

- Access for emergency vehicles and local residents living within the immediate work zone will be maintained.
- Trash collection should remain unaffected but may be earlier in the morning on that day.
- Pedestrians will continue to have access to PRT Ingram Station.

We understand that roadwork can be a hassle and sincerely appreciate your patience as we make these necessary improvements to our infrastructure. **An Informational Public Meeting will be held April 21, 2026 from 7:00 p.m. – 8:00 p.m. at Ingram Borough building in Memorial Hall.**

Thank you.
Ingram Borough

DISTRICT	COUNTY	ROUTE	SECTION	SHEET
11-0	ALLEGHENY			2 OF 3
HERRMAN BOROUGH				

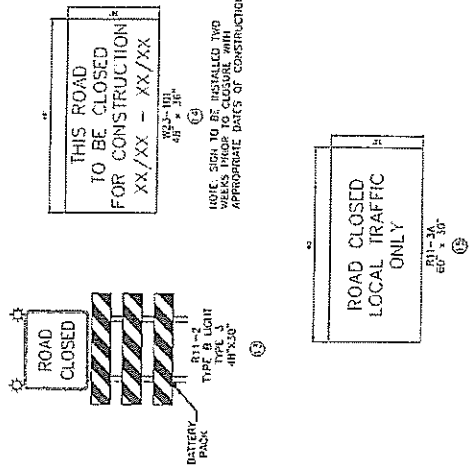
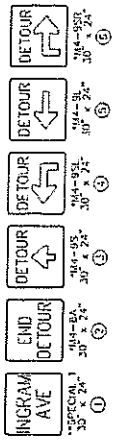
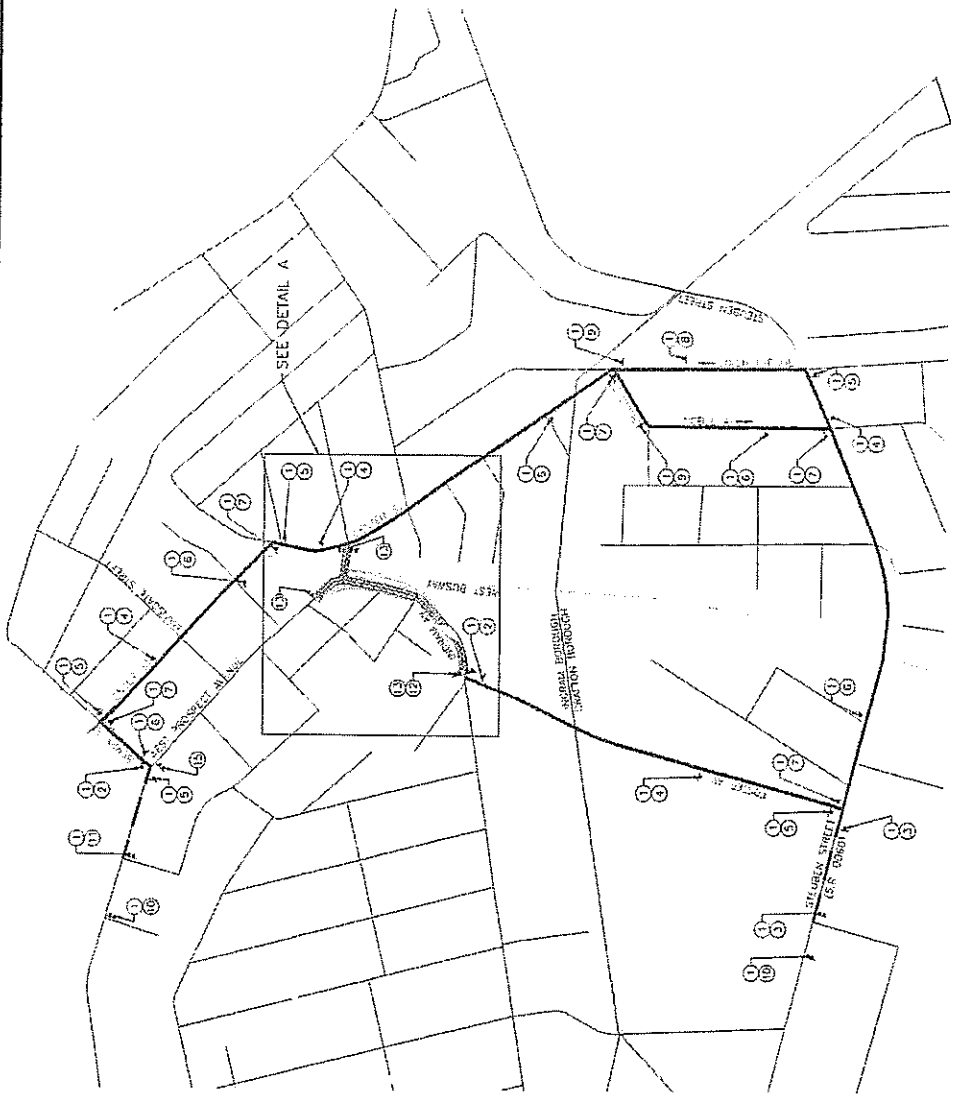

- LEGEND**
- ROADS AND STREETS
 - 4 (1) DETOUR ROUTE SIGNING
 - (1) TYPE III BARRIERS
 - LEAD IN ROUTE
 - DETOUR ROUTE
 - MUNICIPAL BOUNDARY

- Closure

- Detour Route

GATEWAY ENGINEERS
A FULL SERVICE CIVIL ENGINEERING FIRM

DETOUR PLAN
HERRMAN AVENUE/WEST PROSPECT AVENUE

THE GATEWAY ENGINEERS, INC. RETAINS OWNERSHIP RIGHTS OF ALL DATA WITHIN THE PLANS. DATA CONTAINED HEREIN IS ONLY TO BE USED FOR ITS INTENDED PURPOSE BY ITS RESPONSIBLE PARTY. THE USE, REPLICATION, REPRODUCTION, OR REDISTRIBUTION OF DATA CONTAINED WITHIN IS STRICTLY PROHIBITED AND SUBJECT TO LEGAL ACTION.