

COMMONWEALTH OF PENNSYLVANIA
DEPARTMENT OF TRANSPORTATION
DRAWINGS
FOR
CONSTRUCTION
OF
EUCLID BOULEVARD
ERIE COUNTY
WESLEYVILLE BOROUGH

TABULATION OF OVERALL/CONSTRUCTION LENGTH
FROM STA. 0+00 TO STA. 7+55
LENGTH 755 Ft. 0.143 Mi.

PREPARED BY:
MARK J. COREY & ASSOCIATES
CONSULTING ENGINEERING SERVICES
P.O. BOX 268
HARBORCREEK, PA 16421

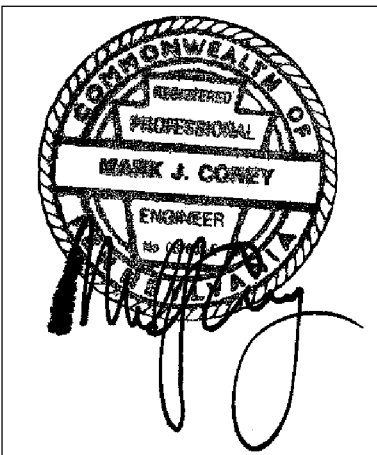

SIGNATURE: _____
DATE: 05/13/26

RECOMMENDED _____ DATE: _____

DISTRICT EXECUTIVE

DISTRICT	COUNTY	ROUTE	SECTION	SHEET
1-0	ERIE	---	---	2 OF 8
WESLEYVILLE BOROUGH				
REVISION NUMBER	REVISIONS			DATE BY

PUBLIC UTILITIES

THREE WORKING DAYS PRIOR TO START OF WORK
 THE CONTRACTOR MUST CONTACT THE
 PA ONE CALL SYSTEM, INC.
 PHONE 1-800-242-1776
 DESIGN ONE CALL
 SERIAL #20251192167

UTILITY INVOLVEMENT

WESLEYVILLE BOROUGH
 ATTN: MARCUS JACOBS
 marcus@wesleyville.gov

EVERSTREAM
 ATTN: GEORGE CASSIDY
 gcassidy@everstream.net

CHARTER COMMUNICATIONS
 ATTN: MELISSA WATERS
 melissa.waters@charter.com

NATIONAL FUEL GAS DISTRIBUTION CORP.
 ATTN: BRANDT BAUER
 bauerb1@natfuel.com

VERIZON NORTH
 ATTN: VICTOR WOOD
 victor.s.wood@verizon.com

ERIE WATER WORKS
 ATTN: CHAD ELLSWORTH
 cellsworth@eriewaterworks.com

PENNSYLVANIA ELEC. COMPANY
 ATTN: MELLYSSA ADAMS
 madams@firstenergycorp.com

GENERAL NOTES:

ALL WORK CONTEMPLATED ON THIS PROJECT IS CONFINED WITHIN THE EXISTING HIGHWAY RIGHT-OF-WAY.

CONSTRUCT PROJECT IN ACCORDANCE WITH SPECIFICATIONS, PUBLICATION 408, 2020.

EXISTING CURB RAMPS THAT ARE COMPLIANT SHALL REMAIN.

THIS IS A FEDERAL-AID PROJECT AND AS SUCH IS SUBJECT TO INSPECTION BY REPRESENTATIVES OF THE FEDERAL HIGHWAY ADMINISTRATION, THE PENNSYLVANIA DEPARTMENT OF TRANSPORTATION, AND WESLEYVILLE BOROUGH.

THE LIMITS OF WORK ON THE INTERSECTING SIDE STREETS SHALL BE 25 FEET BEYOND THE RIGHT-OF-WAY LINE OF EUCLID BOULEVARD (EXCEPT AS OTHERWISE SHOWN).

DETAILS, OTHER THAN THOSE INDICATED, ARE ON THE FOLLOWING STANDARD DRAWINGS:

ROADWAY STANDARDS

RC-28M	NOV 1, 2022
RC-30M	FEB 27, 2023
RC-64M	FEB 19, 2021
RC-67M	FEB 19, 2021
RC-72M	FEB 8, 2019
TC-8702B	JUNE 13, 2013

RIGHT-OF-WAY BASIS

THE LEGAL RIGHT-OF-WAY OF EUCLID BOULEVARD, FROM GROVELAND AVENUE TO STATION ROAD, IS 75 FEET IN WIDTH BASED ON THE BIRD REAL ESTATE & IMPROVEMENT COMPANY MAP OF LOTS, RECORDED IN MAP BOOK VOLUME 2, PAGES 112 & 113

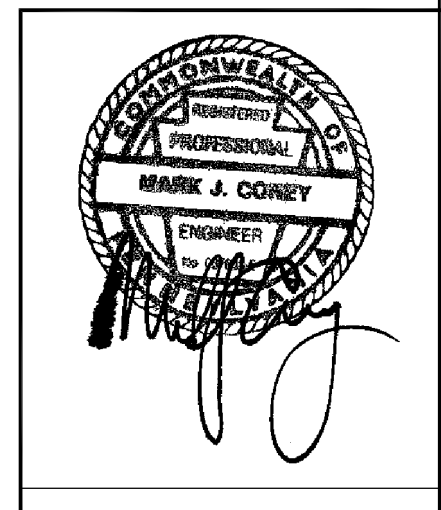

DISTRICT	COUNTY	ROUTE	SECTION	SHEET	
1-0	ERIE	---	---	3 OF 8	
WESLEYVILLE BOROUGH					
REVISION NUMBER	REVISIONS			DATE	BY

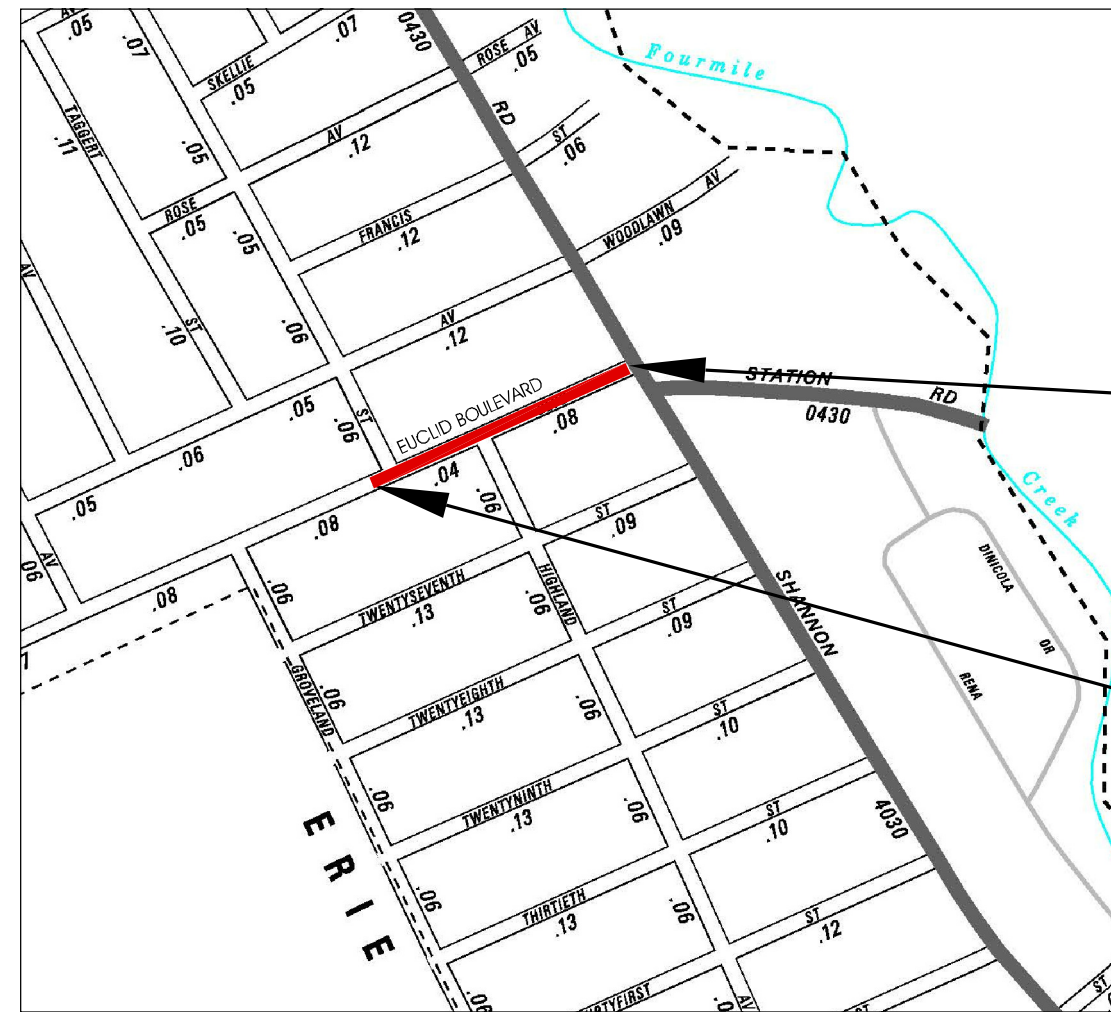

LIMIT OF WORK
 EUCLID BOULEVARD
 STA. 7+55
 WESLEYVILLE BOROUGH
 ERIE COUNTY

LIMIT OF WORK
 EUCLID BOULEVARD
 STA. 0+00
 WESLEYVILLE BOROUGH
 ERIE COUNTY

LOCATION MAP

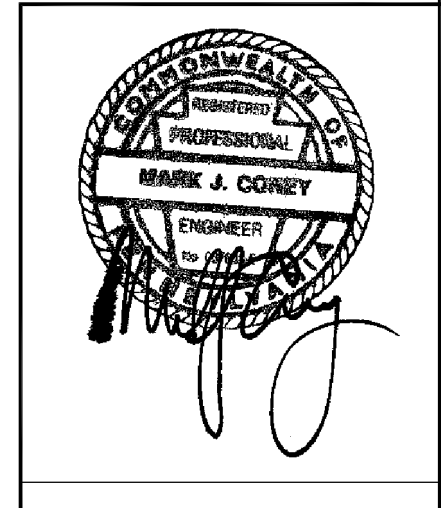
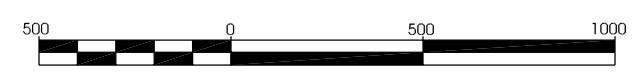



LEGEND

- LIMITS OF PAVEMENT
- LIMITS OF CONCRETE DRIVEWAY

DISTRICT	COUNTY	ROUTE	SECTION	SHEET	
1-0	ERIE	---	---	5 OF 8	
WESLEYVILLE BOROUGH					
REVISION NUMBER	REVISIONS			DATE	BY

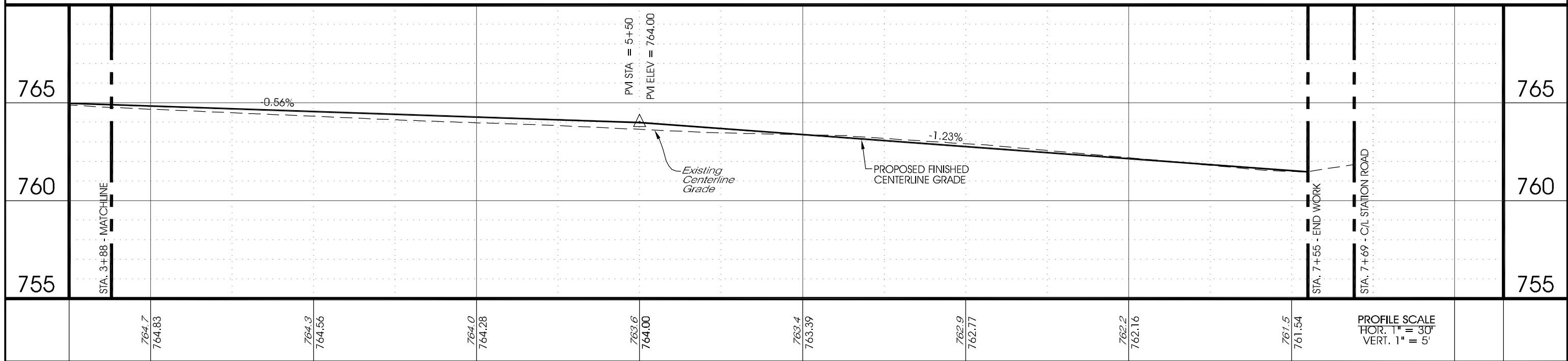
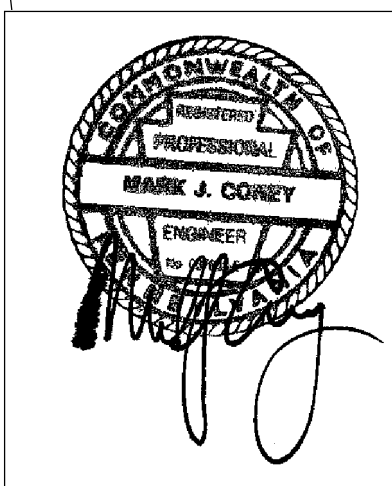
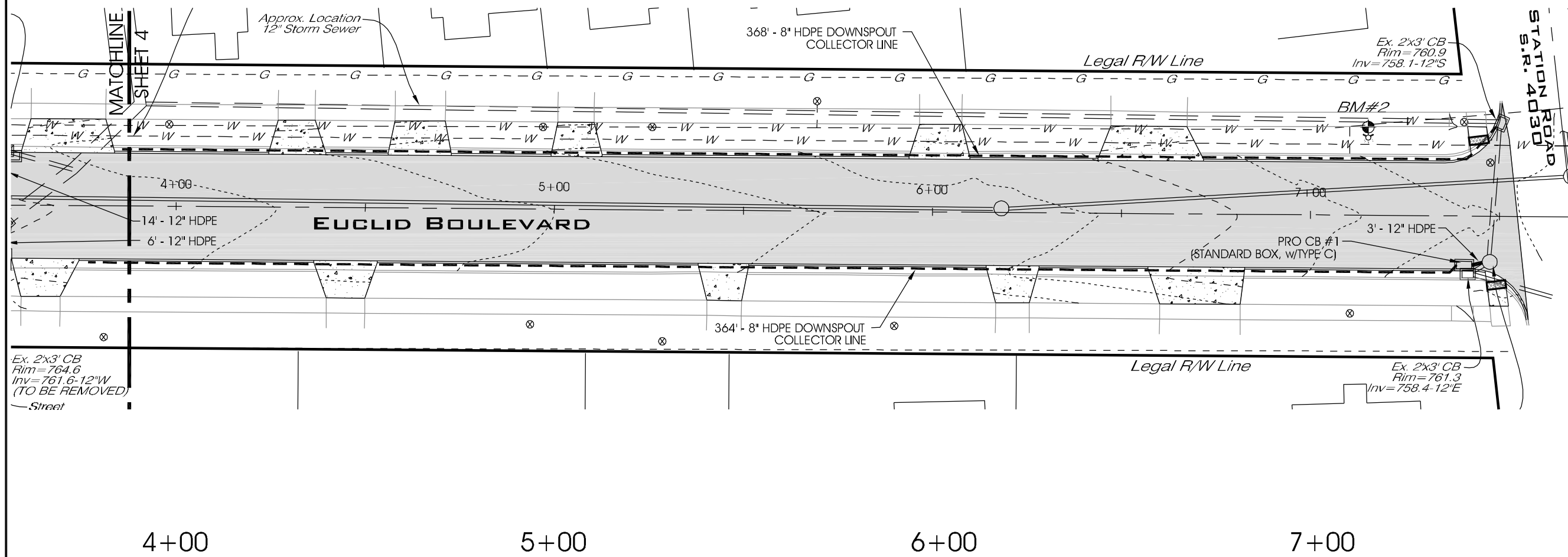

DISTRICT	COUNTY	ROUTE	SECTION	SHEET	
1-0	ERIE	---	---	6 OF 7	
WESLEYVILLE BOROUGH					
REVISION NUMBER	REVISIONS			DATE	BY

STATIONS 0+00 TO 0+27
STATION 1+25 TO 7+55

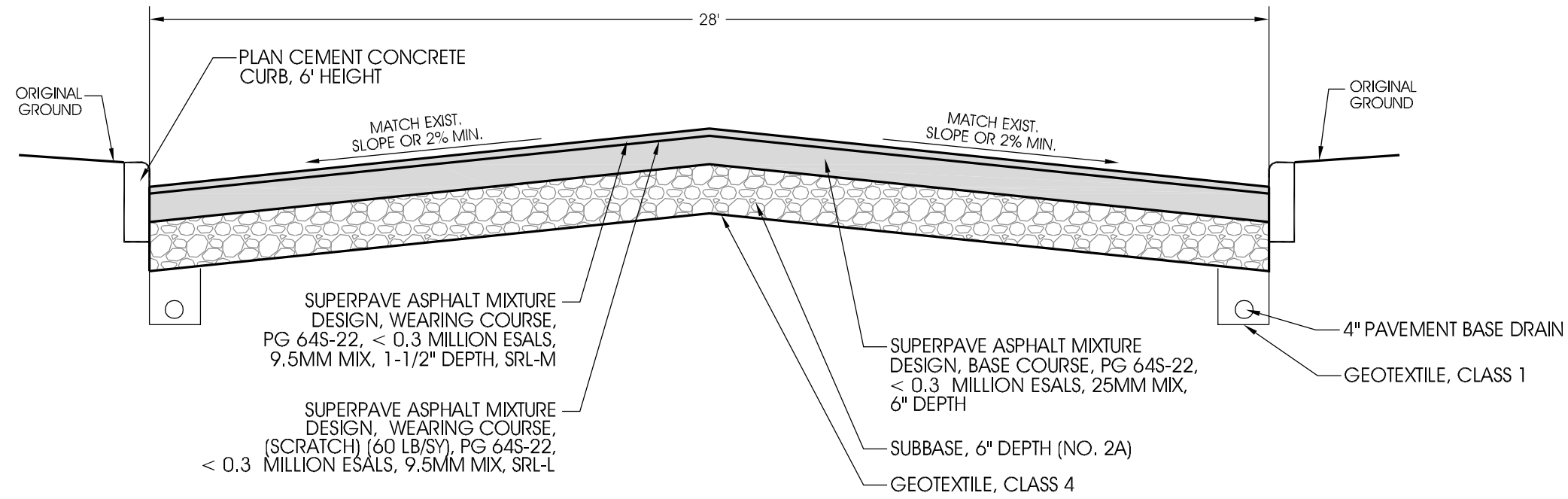

TYPICAL SECTION
NOT TO SCALE

STATION 0+27 TO 1+25

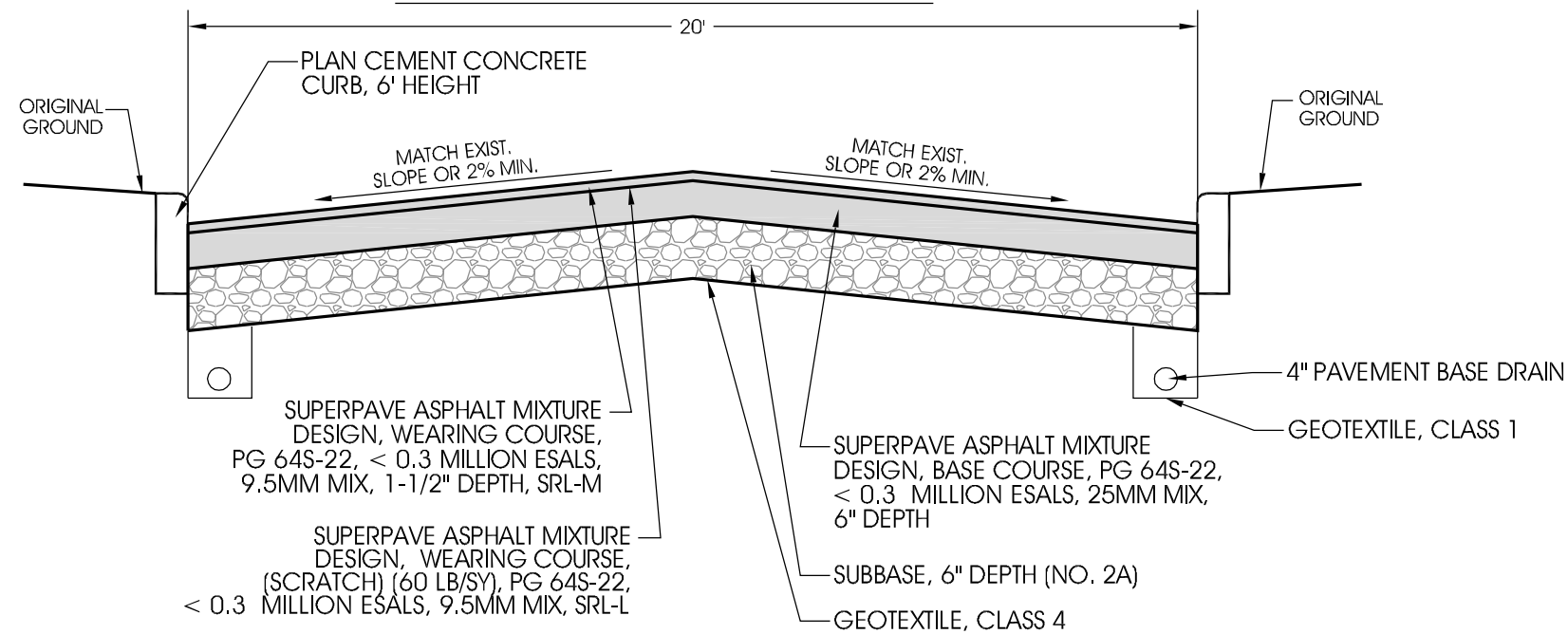

TYPICAL SECTION
NOT TO SCALE

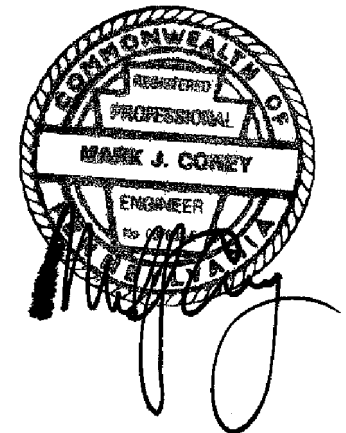

SUMMARY

REVISION NO.	REVISIONS	DATE	BY	DISTRICT	COUNTY	ROUTE	SECTION	SHEET
				1-0	ERIE	---	---	7 OF 8

QUANTITY	ITEM NO.	DESCRIPTION	DESIGN NO.	FOR TAB SEE SHEET	QUANTITY	ITEM NO.	DESCRIPTION	DESIGN NO.	FOR TAB SEE SHEET	QUANTITY	ITEM NO.	DESCRIPTION	DESIGN NO.	FOR TAB SEE SHEET	QUANTITY	ITEM NO.	DESCRIPTION	DESIGN NO.	FOR TAB SEE SHEET
	UNIT					UNIT					UNIT					UNIT			
1200	0203 0001	CLASS I EXCAVATION				0689 0001	NARRATIVE SCHEDULE												
	CY					LS													
867	0212 001	GEOTEXTILE, CLASS 1			35	0703 0022	NO. 8 COARSE AGGREGATE												
	SY					CY													
2474	0212 0014	GEOTEXTILE, CLASS 4, TYPE A				0901 0001	MAINTENANCE AND PROTECTION OF TRAFFIC DURING CONSTRUCTION												
	SY					LS													
2474	0313 0326	SUPERPAVE ASPHALT MIXTURE DESIGN, BASE COURSE, PG64S-22, <0.3 MILLION ESALS, 25MM MIX, 6" DEPTH			69	4676 0001	CONCRETE SIDEWALK, 4", MODIFIED												
	SY					SY													
2474	0413 0194	SUPERPAVE ASPHALT MIXTURE DESIGN, WEARING COURSE, PG 64S-22, < 0.3 MILLION ESALS, 9.5MM MIX, 1-1/2" DEPTH, SRL-H			288	4676 0005	DRIVEWAY APRONS AND SIDEWALK THROUGH DRIVEWAYS												
	SY					SY													
2474	0413 1019	SUPERPAVE ASPHALT MIXTURE DESIGN, WEARING COURSE, (SCRATCH) (60 LB/SY), PG 64S-22, < 0.3 MILLION ESALS, 9.5MM MIX, SRL-L			14	4695 0004	DETECTABLE WARNING SURFACE, POLYMER COMPOSITE COLOR SPECIFIC												
	TONS					EA													
2474	0460 0003	ASPHALT TACK COAT (NTT / CNTT)			14	9000 5002	CURB RAMP ANALYSIS WITH LIMITED SUBMISSIONS												
	SY					EA													
23	0601 0311	12" THERMOPLASTIC PIPE, GROUP I, 15'-1.5' FILL				9000 5101	ELECTRONIC TICKETING (E-TICKETING) FOR CONSTRUCTION AGGREGATE												
	LF					LS													
1	0605 2401	MANHOLE FRAME AND COVER				9000 5103	ELECTRONIC TICKETING (E-TICKETING) FOR CONSTRUCTION CONCRETE												
	EA					LS													
5	0605 2770	TYPE C FRAME AND BICYCLE SAFE GRATE																	
	EA																		
6	0605 2850	STANDARD INLET BOX, < / = 10"																	
	EA																		
	0608 0001	MOBILIZATION																	
	LS																		
	0609 0004	INSPECTOR'S FIELD OFFICE AND INSPECTION FACILITIES, TYPE C																	
	LS																		
	0609 0009	EQUIPMENT PACKAGE																	
	LS																		
1560	0610 7002	6" PAVEMENT BASE DRAIN																	
	LF																		
1568	0630 0035	PLAIN CEMENT CONCRETE CURB, 6" HEIGHT, INCLUDING REMOVAL OF EXISTING CURB																	
	LF																		
28	0676 0001	CEMENT CONCRETE SIDEWALK																	
	SY																		
	0688 0020	MICROCOMPUTER, TYPE C																	
	LS																		

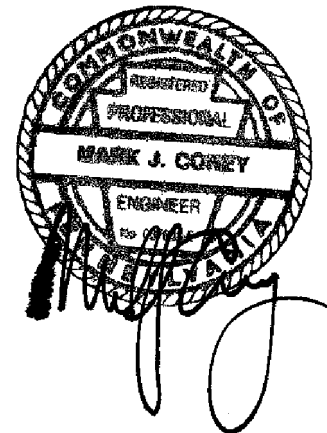

TABULATION OF QUANTITIES

ROADWAY

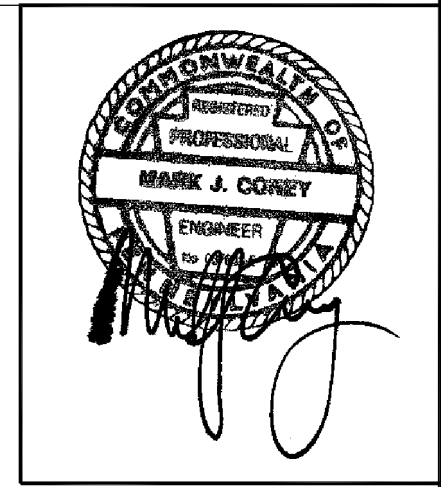

0203 0001 CY	0212 0001 SY	0212 0014 SY	0313 0326 SY	0413 0194 SY	0413 1019 SY	0460 0003 SY	0601 0311 EA	0605 2401 EA	0605 2770 EA	0605 2860 EA	0610 7002 LF	0630 0035 LF	0676 0001 SY	0703 0022 CY	4676 0001 SY	4676 0005 SY	4695 0004 EA	9000 5002 EA	ITEM NUMBER	UNIT	REMARKS	SIDE	STATIONS
1200	867	2474	2474	2474	2474	2474	23	1	5	6	1560	1568	28	35	69	288	14	14			ENTIRE PROJECT		
1044	867	2474	2474	2474	2474	2474	23	1	5	6	1560	1568	28	35	69	288	14	14			TOTALS		