

DISTRICT	COUNTY	ROUTE	SECTION	SHEET	
8-0	YORK	0074	069	1 OF 4	
DOVER AND WARRINGTON TOWNSHIPS					
REVISION NUMBER	REVISIONS			DATE	BY

GENERAL NOTES

THIS WORK CONSISTS OF THE MAINTENANCE AND PROTECTION OF TRAFFIC AND THE PROTECTION OF THE TRAVELING PUBLIC APPROACHING THE CONSTRUCTION AREA AND WITHIN THE LIMITS OF CONSTRUCTION AND APPROVED DETOUR ROUTES.

FURNISH, ERECT, PLACE AND MAINTAIN TRAFFIC CONTROL SIGNS AND DEVICES. MAINTAIN TRAFFIC DURING HOURS OF CONSTRUCTION AND AT ALL OTHER TIMES IN ACCORDANCE WITH THE METHODS INDICATED ON THESE DRAWINGS AND THE FOLLOWING:

1. SPECIAL PROVISIONS OF THE CONTRACT.
2. FHWA - MANUAL ON UNIFORM TRAFFIC CONTROL DEVICES (MUTCD)
3. PENNDOT PUBLICATION 35, APPROVED CONSTRUCTION MATERIALS (BULLETIN 15)
4. PENNDOT PUBLICATION 46, TRAFFIC ENGINEERING MANUAL
5. PENNDOT PUBLICATION 212, OFFICIAL TRAFFIC CONTROL DEVICES, SUBCHAPTER E
6. PENNDOT PUBLICATION 213, TEMPORARY TRAFFIC CONTROL GUIDELINES
7. PENNDOT PUBLICATION 236, HANDBOOK OF APPROVED SIGNS
8. PENNDOT PUBLICATION 408, SPECIFICATIONS (CURRENT LET DATE EDITION)
9. PENNDOT PUBLICATION 111, TRAFFIC CONTROL PAVEMENT MARKING AND SIGNING STANDARDS.

THE INSPECTOR-IN-CHARGE WILL INSPECT ALL TRAFFIC CONTROL DEVICES PRIOR TO THE START OF WORK AND PERIODICALLY DURING THE LIFE OF THE PROJECT.

THESE PLANS HAVE BEEN REVIEWED AND ARE IN COMPLIANCE WITH STANDARDS PRESCRIBED IN CHAPTER 212 OF THE TITLE 67 PA CODE AS CURRENTLY AMENDED. THE APPROVAL OF THIS TRAFFIC CONTROL PLAN IS NOT INTENDED TO RELIEVE THE CONTRACTOR OF THE RESPONSIBILITY FOR THE PROTECTION OF THE PUBLIC AND THE CONSTRUCTION PERSONNEL. STANDARDS SPECIFIED IN SECTION 901.3(d) OF PENNDOT PUBLICATION 408 ARE MINIMUM AND ADDITIONAL PROTECTION MAY BE NEEDED IF PROBLEMS ARE ENCOUNTERED DURING THE TERM OF THE CONTRACT. CONSTANTLY REVIEW THIS PLAN FOR ADEQUACY AND RECOMMEND CHANGES FOR DEPARTMENT APPROVAL WHEN INADEQUACIES ARE DISCOVERED.

NOTIFY THE DISTRICT 8-0 PRESS OFFICE AT 717-787-1446 AND YORK COUNTY MAINTENANCE AT 717-848-6230, TWO (2) WEEKS IN ADVANCE OF ANY LANE SHIFTS, LANE CLOSURES OR RESTRICTIONS.

NOTIFY THE DISTRICT 8-0 TRAFFIC MANAGEMENT CENTER, 717-265-7600, TWO (2) DAYS IN ADVANCE OF ANY PROPOSED LANE OR SHOULDER RESTRICTIONS OR LANE SHIFTS, AND FIFTEEN (15) MINUTES PRIOR TO THE START OF WORK. THE CONTRACTOR MUST NOTIFY THE TRAFFIC MANAGEMENT CENTER WHEN THE ROAD IS RESTORED TO NORMAL OPERATION.

NO TOWNSHIP ROAD SHALL BE USED FOR STOCKPILING OR TRANSPORT OF EQUIPMENT OR MATERIALS.

SR 74 IS TO BE DETOURED FOR NO LONGER THAN (240) CONSECUTIVE DAYS.

DO NOT INITIATE THE DETOUR FOR SR 74 SEC 069 UNTIL THE COMPLETION OF MPMS PROJECT NO. 81070, SR 4014 SEC 008 (HARMONY GROVE RD).

RECOMMENDED: August 9th, 2024 DATE: 8/9/2024

Michael E. Reeder Digitally signed by Michael E. Reeder, PE Date: 2024.08.09 09:40:20 -04'00'

ADE - CONSTRUCTION

RECOMMENDED August 8th 20 24

Matthew S. Clouser Digitally signed by Matthew S. Clouser Date: 2024.08.08 14:29:48 -04'00'

for DISTRICT TRAFFIC ENGINEER

TRAFFIC CONTROL PLAN

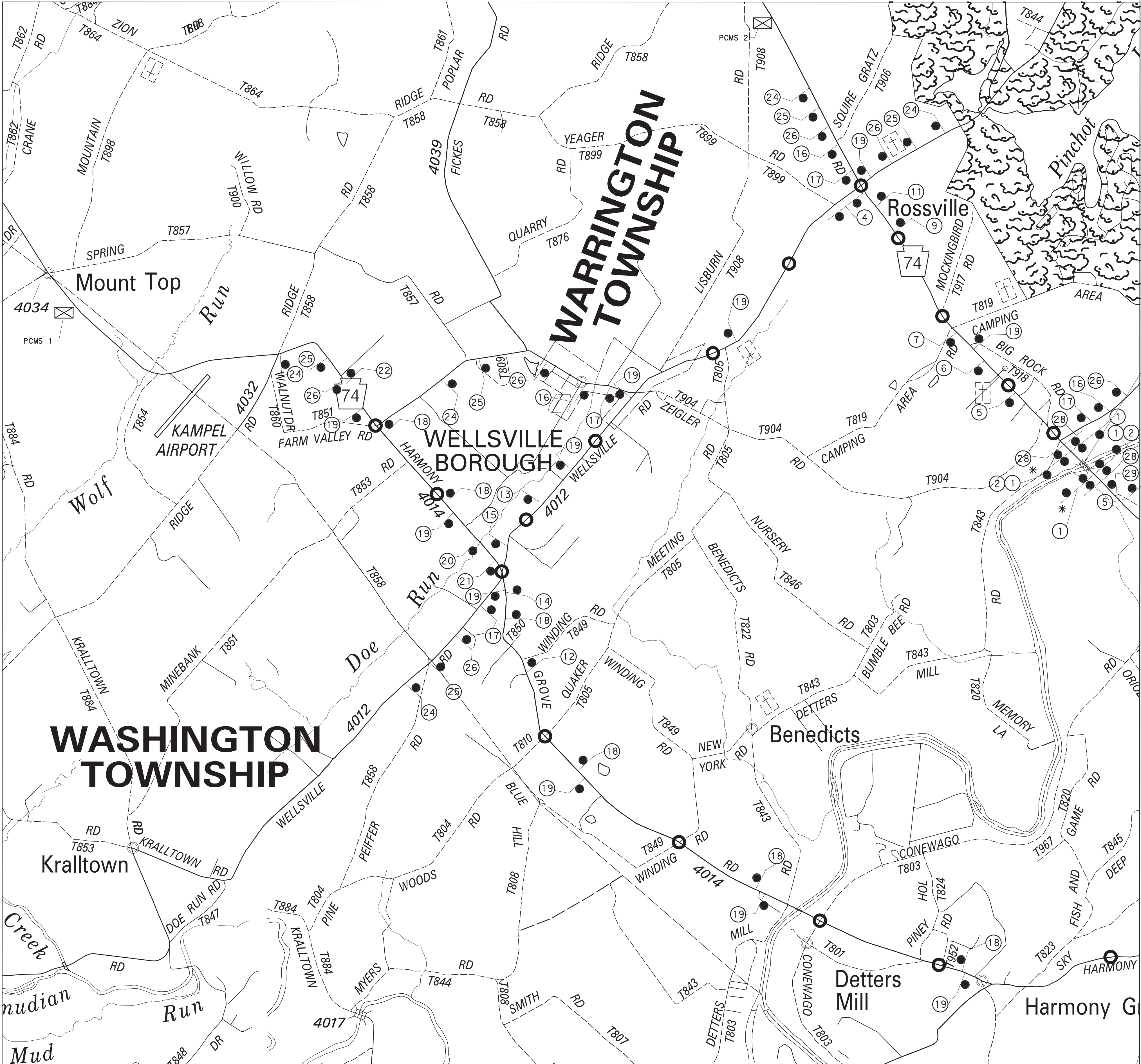

PROJECT LOCATION

MATCH LINE - SEE SHEET 2

LEGEND

- WORK AREA
- TOWNSHIP ROAD
- STATE HIGHWAY
- MUNICIPAL BOUNDARY
- SIGN
- TYPE III BARRICADE
- DETOUR ROUTE
- EXTEND TYPE III BARRICADE ACROSS ENTIRE ROADWAY
- TOWNSHIP ROUTE NO.
- STATE ROUTE NO.
- PORTABLE CHANGEABLE MESSAGE SIGN (PCMS)

PREPARED BY  
LARSON DESIGN GROUP  
4999 LOUISE DRIVE, SUITE 100  
MECHANICSBURG, PA 17055

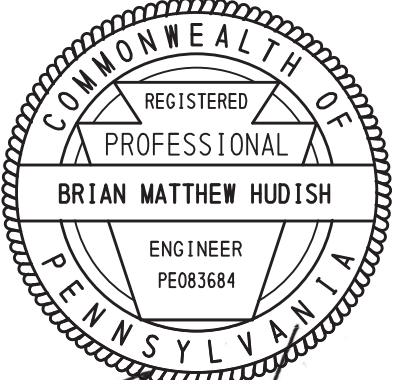

REG. PROF. ENGINEER

7/9/2024

DATE

DETOUR LENGTH = 8.50 MILES

DETOUR MAP



DESIGNER: JAG DRAFTER: JAG CHECKER: CWF JOB #: 5486-066

DATE: 7/8/2024  
TIME: 5:54 PM  
USER: jg11  
MODEL: DetFault  
PLOT DRIVER: \$XOPERATIONS\CAD\Transportat\ton\LDG\_Workspace\CL\ENT\LDG\plot\pdf-permdot-bw.plt  
PEN TABLE: PENBTL



DISTRICT	COUNTY	ROUTE	SECTION	SHEET	
8-0	YORK	0074	069	2 OF 4	
DOVER AND WARRINGTON TOWNSHIPS					
REVISION NUMBER	REVISIONS			DATE	BY

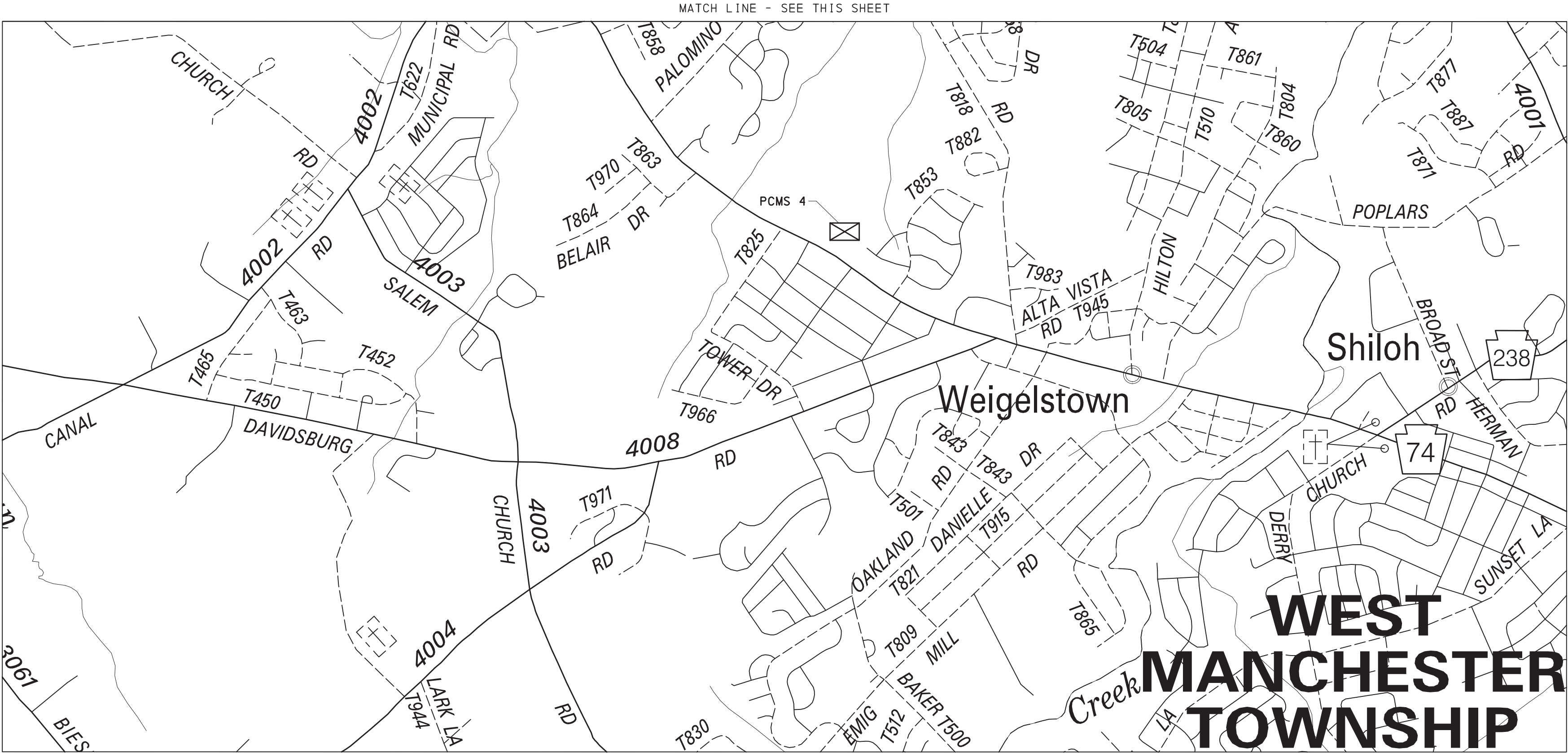
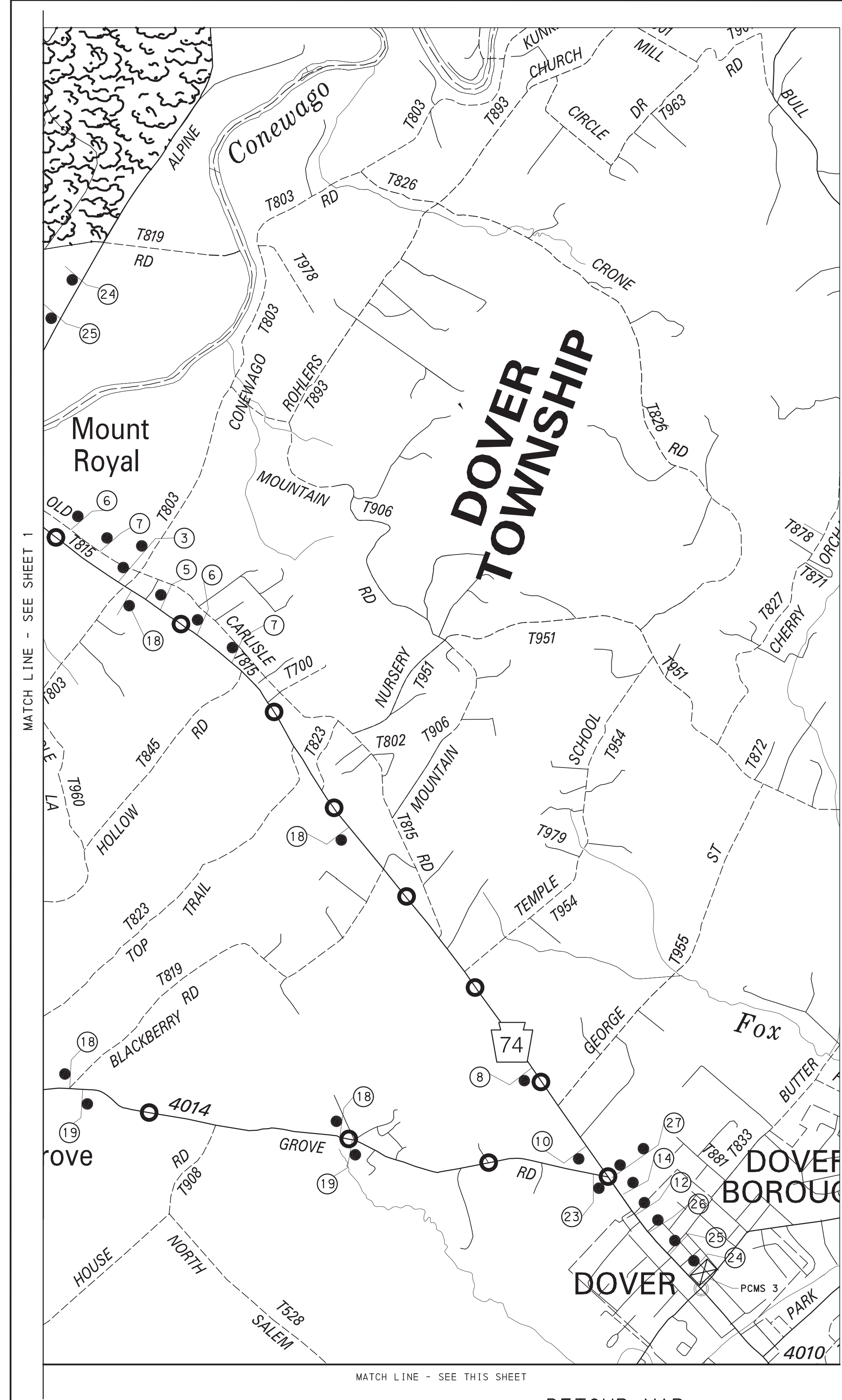

- LEGEND**
- WORK AREA
  - TOWNSHIP ROAD
  - STATE HIGHWAY
  - MUNICIPAL BOUNDARY
  - SIGN
  - TYPE III BARRICADE
  - DETOUR ROUTE
  - EXTEND TYPE III BARRICADE ACROSS ENTIRE ROADWAY
  - TOWNSHIP ROUTE NO.
  - STATE ROUTE NO.
  - PORTABLE CHANGEABLE MESSAGE SIGN (PCMS)

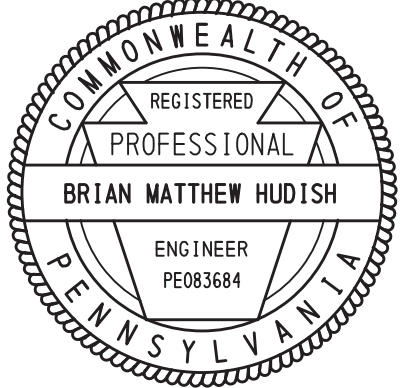

DATE: 7/8/2024 1:00 PM  
FILE: S:\Projects\5486-066-P7\CAD\02\_Highway\TCP\5486-066-P7-SR\_74 - TCPgn001.dgn  
USER: JAG  
MODEL: Detour.dwg  
PLOT: DRIVER: S:\OPERATIONS\CAD\Transportation\LDG\_Workspace\CLIENT\LDG\plot\pdf-permdot-bw.plt  
PEN: TABLE: PENTBL



DISTRICT	COUNTY	ROUTE	SECTION	SHEET	
8-0	YORK	0074	069	3 OF 4	
DOVER AND WARRINGTON TOWNSHIPS					
REVISION NUMBER	REVISIONS			DATE	BY

①

BRIDGE  
CLOSED

R11-2-1  
48"X30"

EXTEND  
TYPE III  
BARRICADES  
ACROSS ENTIRE  
ROADWAY

②

THIS BRIDGE  
TO BE CLOSED  
FOR CONSTRUCTION  
<DATE>

W23-101  
96"X48"

TYPE III  
BARRICADE

③

R11-3A  
60" x 30"  
R11-3B  
48" x 12"

BRIDGE OUT  
5/8 MILE AHEAD  
LOCAL TRAFFIC ONLY

TYPE III  
BARRICADE

④

R11-3A  
60" x 30"  
R11-3B  
48" x 12"

BRIDGE OUT  
1-5/8 MILES AHEAD  
LOCAL TRAFFIC ONLY

M4-10R  
48" x 18"  
TYPE III  
BARRICADE

DETOUR

⑤

ROAD  
CLOSED  
500 FT

W20-3  
36"X36"  
W30-1-1

TYPE B

⑥

ROAD  
CLOSED  
1000 FT

W20-3  
36"X36"  
W30-1-2

TYPE B

⑦

ROAD  
CLOSED  
1500 FT

W20-3  
36"X36"  
W30-1-3

TYPE B

⑧

DETOUR  
NORTH

74

M4-8  
24"X12"  
M3-1  
24"X12"  
M1-5  
30"X24"  
M5-1R  
21"X15"

TYPE B

⑨

DETOUR  
SOUTH

74

M4-8  
24"X12"  
M3-3  
24"X12"  
M1-5  
30"X24"  
M5-1L  
21"X15"

TYPE B

⑩

DETOUR  
NORTH

74

M4-8  
24"X12"  
M3-1  
24"X12"  
M1-5  
30"X24"  
M6-1  
21"X15"

TYPE B

⑪

DETOUR  
SOUTH

74

M4-8  
24"X12"  
M3-3  
24"X12"  
M1-5  
30"X24"  
M6-1  
21"X15"

TYPE B

⑫

DETOUR  
NORTH

74

M4-8  
24"X12"  
M3-1  
24"X12"  
M1-5  
30"X24"  
M5-2L  
21"X15"

TYPE B

⑬

DETOUR  
SOUTH

74

M4-8  
24"X12"  
M3-3  
24"X12"  
M1-5  
30"X24"  
M5-2L  
21"X15"

TYPE B

⑭

DETOUR  
NORTH

74

M4-8  
24"X12"  
M3-1  
24"X12"  
M1-5  
30"X24"  
M6-2L  
21"X15"

TYPE B

⑮

DETOUR  
SOUTH

74

M4-8  
24"X12"  
M3-3  
24"X12"  
M1-5  
30"X24"  
M6-2L  
21"X15"

TYPE B

⑯

DETOUR  
SOUTH

74

M4-8  
24"X12"  
M3-3  
24"X12"  
M1-5  
30"X24"  
M5-1R  
21"X15"

TYPE B

⑰

DETOUR  
SOUTH

74

M4-8  
24"X12"  
M3-3  
24"X12"  
M1-5  
30"X24"  
M6-1  
21"X15"

TYPE B

⑱

DETOUR  
NORTH

74

M4-8  
24"X12"  
M3-1  
24"X12"  
M1-5  
30"X24"  
M6-3  
21"X15"

TYPE B

⑲

DETOUR  
SOUTH

74

M4-8  
24"X12"  
M3-3  
24"X12"  
M1-5  
30"X24"  
M6-3  
21"X15"

TYPE B

⑳

DETOUR  
SOUTH

74

M4-8  
24"X12"  
M3-3  
24"X12"  
M1-5  
30"X24"  
M5-2R  
21"X15"

TYPE B

㉑

DETOUR  
SOUTH

74

M4-8  
24"X12"  
M3-3  
24"X12"  
M1-5  
30"X24"  
M6-2R  
21"X15"

TYPE B

㉒

END  
DETOUR

NORTH

74

M4-8A  
24"X18"  
M3-1  
24"X12"  
M1-5  
30"X24"

TYPE B

TABULATION OF TRAFFIC CONTROL DEVICES INCLUDED IN ITEM 0901-0001 (FOR INFORMATION ONLY)			
STD. NO.	SIZE	DESCRIPTION	QTY
M1-5	30" X 24"	PENNSYLVANIA ROUTE (MARKER)	45
M3-1	24" X 12"	NORTH (MARKER)	18
M3-3	24" X 12"	SOUTH (MARKER)	27
M4-8	24" X 12"	DETOUR (MARKER)	43
M4-8A	24" X 18"	END DETOUR	2
M4-10R	48" X 18"	DETOUR ARROW, RIGHT	1
M4-10L	48" X 18"	DETOUR ARROW, LEFT	1
M5-1L	21" X 15"	ADVANCE 90° LEFT TURN (MARKER)	1
M5-1R	21" X 15"	ADVANCE 90° RIGHT TURN (MARKER)	4
M5-2L	21" X 15"	ADVANCE 45° LEFT TURN (MARKER)	3
M5-2R	21" X 15"	ADVANCE 45° RIGHT TURN (MARKER)	1
M6-1	21" X 15"	90° TURN (MARKER)	7
M6-2L	21" X 15"	45° LEFT TURN (MARKER)	3
M6-2R	21" X 15"	45° RIGHT TURN (MARKER)	1
M6-3	21" X 15"	STRAIGHT THROUGH (MARKER)	23
R11-2-1	48" X 30"	BRIDGE CLOSED	4
R11-3A	60" X 30"	ROAD CLOSED - LOCAL TRAFFIC ONLY	3
R11-3B	48" X 12"	BRIDGE OUT - LOCAL TRAFFIC ONLY	3
W20-2	36" X 36"	ADVANCE DETOUR	21
W20-3	36" X 36"	ROAD CLOSED	9
W23-101	96" X 48"	THIS BRIDGE TO BE CLOSED FOR CONSTRUCTION	2
W25-5	36" X 36"	CONSTRUCTION ENTRANCE AHEAD	4
W30-1-1	20" X 6"	DISTANCE (500 FT) (PANEL)	10
W30-1-2	20" X 6"	DISTANCE (1000 FT) (PANEL)	10
W30-1-3	20" X 6"	DISTANCE (1500 FT) (PANEL)	10
		TYPE III BARRICADE	*
		TYPE B BREAKAWAY POST	*
----	⚡	TYPE B LIGHT	*

\*SUFFICIENT QUANTITY  
SIZES SHOWN ARE MINIMUM REQUIREMENTS

ADDITIONAL TRAFFIC CONTROL PAY ITEMS			
ITEM NUMBER	UNIT	DESCRIPTION	QTY
0901-0240	SF	ADDITIONAL TRAFFIC CONTROL SIGNS	200
0901-0451	EACH	3-LINE CHANGEABLE MESSAGE SIGN WITHOUT TELECOMMUNICATIONS	4

SCREEN 1 SCREEN 2

PCMS1

SR 74  
CLOSED  
AHEAD

USE  
HARMONY  
GROVE RD

PLACE PCMS ON SR 74 SOUTHBOUND  
AFTER INTERSECTION OF SR 4034

SCREEN 1 SCREEN 2

PCMS2

SR 74  
CLOSED  
AHEAD

USE  
WELLSVILLE  
RD

PLACE PCMS ON SR 4026 SOUTHBOUND  
AFTER INTERSECTION OF  
T-908 (LISBURN RD)

SCREEN 1 SCREEN 2

PCMS3

SR 74  
CLOSED  
AHEAD

USE  
HARMONY  
GROVE RD

PLACE PCMS ON SR 74 NORTHBOUND  
AT INTERSECTION OF SR 921,  
DO NOT BLOCK ENTIRE SIDEWALK

SCREEN 1 SCREEN 2

PCMS4

SR 74  
CLOSED  
AHEAD

USE  
HARMONY  
GROVE RD

PLACE PCMS ON SR 74 NORTHBOUND  
AFTER INTERSECTION OF SR 4008

PORTABLE CHANGEABLE MESSAGE  
SIGN MESSAGES

NOTES: ONLY THE INSPECTOR-IN-CHARGE WILL HAVE  
THE AUTHORITY TO DIRECT CHANGES TO  
LOCATION AND MESSAGE DISPLAYED ON PCMS.

DATE: 7/8/2024 1:55:57 PM  
FILE: E:\pwworkspace\Projects\5486-066-P7\CAD\02\_Highway\TCP\5486-066-P7-SR 74 - TCPgn001.dgn  
USER: JG111111  
MODEL: Default  
PLOT DRIVER: \$s:\OPERATIONS\CAD\Transportation\LDG\_Workspace\CLIENT\LDG\plot\pdf-penmodr-bw.plt;cfgr  
PEN TABLE: PEN1BL

DESIGNER: JAG DRAFTER: JAG CHECKER: CWF JOB #: 5486-066

# TABULATION OF QUANTITIES

## TRAFFIC CONTROL PLAN

REVISION NO	REVISIONS	DATE	BY	DISTRICT	COUNTY	ROUTE	SECTION	SHEET
				08	YORK	74	069	4 OF 4

[illegible]